

# Technical Sheet

**Jemi** Simply built to last

Professional Dishwashing and Cooking Equipment

## Cookers 1000 EV Series Electric Bain-Marie

Selva de Mar, 122-128  
08020 Barcelona, España  
Tel. 0034 93 308 31 54  
Fax. 0034 93 303 38 73  
jemi@jemi.es  
www.jemi.es

### Mod. BME50 EV

#### Characteristics

Externals dimensions 450 x 1000 x 850 mm.

Weight 82 Kg.

Voltage 400V. III + N + T

Interior dimensions 305 x 687 x 170 mm.

GN 1/1 + GN 1/3

Litres 27

Electric power 3 Kw.



#### POSSIBLE COMBINATIONS

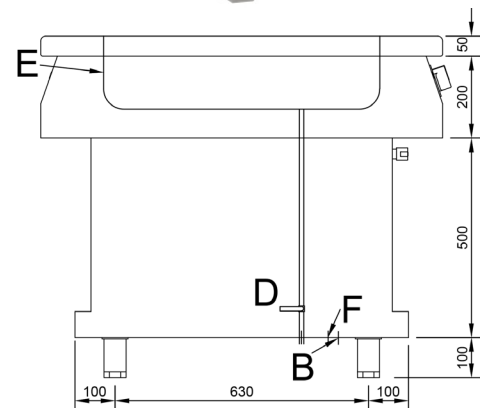
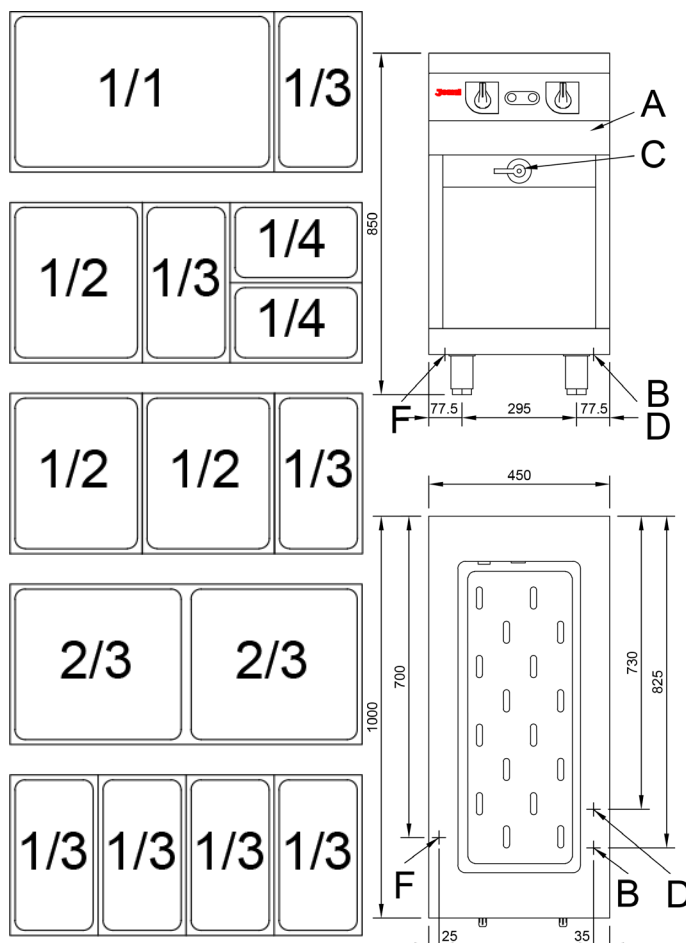

#### Index

- A. Characteristics plate (inside panel)
- B. Water inlet 1/2".
- C. Filling faucet.
- D. Drain.
- E. Water level.
- E. Electric inlet 400V. III + N + T.  
Power: 3 Kw.

