

Technical Sheet

Jemi Simply built to last

Professional Dishwashing and Cooking Equipment

Cookers 750 EV Series Gas grill with water

Selva de Mar, 122-128
08020 Barcelona, España
Tel. 0034 93 308 31 54
Fax. 0034 93 303 38 73
jemi@jemi.es
www.jemi.es

Mod. PG70 EV

Characteristics

External dimensions 400 x 750 x 850 mm.

Weight 75 Kg.

Gas consumption Hi (15°C 1013,25 mbar)

Natural gas H G20 Hi = 34.02 MJ / m³ 0,59

G.P.L. G30 / G31 Hi = 45.65MJ / kg 0,55

Useful area 380 x 475 mm.

Gas inlet 1/2"

Nominal power 7 Kw.

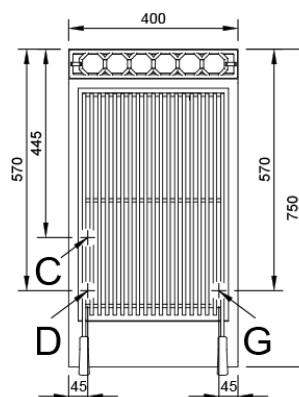
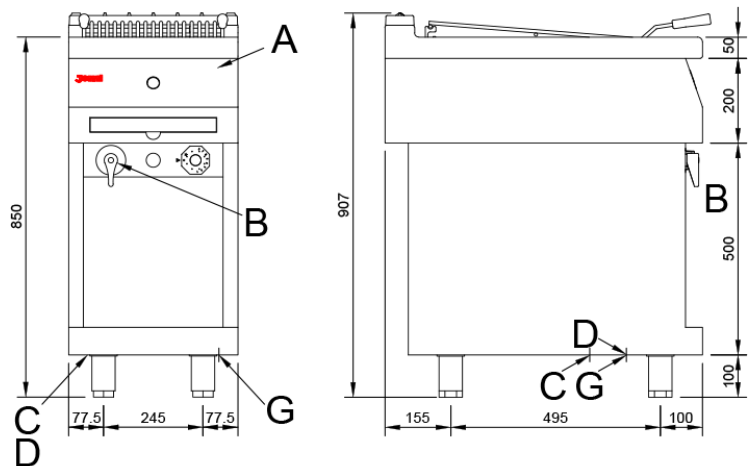

Index

- A. Characteristics plate.
(inside panel)
 - B. Inlet water tap
 - C. Drain ø 18 mm.
 - D. Inlet water 1/2".
 - G. Inlet gas 1/2".
- Power: 7 Kw.
6020 Kcal/h.

